



RP

Series

Features

- High ripple current, Smaller size, Load life of 2000 hours at 105 °C, Used in Inverter welding machine.
- RoHS Compliant Adapted to the RoHS directive.



Specifications

| Items | Performance Characteristics | | |
|---|---|-------------|--|
| Operating Temperature Range | -25~ +105 | | |
| Rated Voltage Range | 200- 450V | | |
| Capacitance Tolerance | ± 20% (120Hz, +20°C) | | |
| Leakage Current | I ≤ 0.01CV (μA) 1.5mA (5%) at 20 °C, after 5 minutes, Whichever is smaller | | |
| (tg) Dissipation Factor (+20 °C, 120Hz) | Rated voltage(V) | 200V ~ 250V | 400- 450V |
| | tg | 0.15 | 0.18 |
| Temperature Characteristics (Impedance ratio at 120Hz) | U _R (V) | 200V ~ 250V | 400- 450 |
| | Z-25 /Z+20 | | 8 |
| Load Life | + 105 °C | 2000 hours | 16 hours |
| | After applying rated voltage with specified ripple current for 2000 hours at +105 °C and then resumed for 16 hours: | | |
| | Capacitance change | ± 20% | ± 20% of the initial measured value |
| | Leakage current | | Initial specified value |
| Shelf Life | + 105 °C | 1000 hours | 30 minutes |
| | After storage for 1000 hours at +105 °C, U _R to be applied for 30 minutes and then resumed for 16 hours: | | |
| | Capacitance change | ± 20% | ± 20% of the initial measured value |
| | Leakage current | | Initial specified value |
| | Dissipation factor | 2 | 2 times of the initial specified value |

Case Table

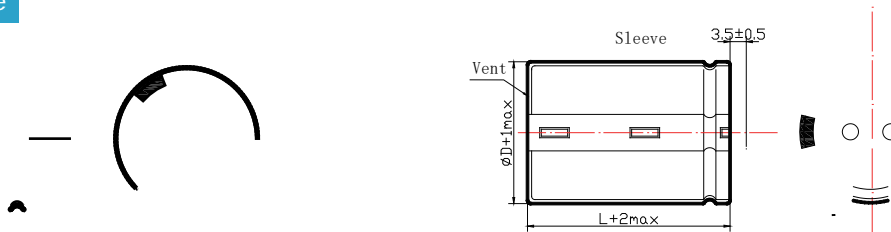

Unit: mm

Frequency Coefficient

| U _R (V) \ (Hz) | 50 | 120 | 300 | 1K | 10K | 100K |
|---------------------------|------|------|------|------|------|------|
| 200- 450 | 0.80 | 1.00 | 1.20 | 1.30 | 1.41 | 1.43 |

s standard when purchasing.

urs!

Capacitance change 20%

±0% of

ed value